

# Replacement of the Watkins Pop-Up Speakers

This instruction outlines the procedure for replacing the Pop-Up Speaker used in the Watkins Spas.

## **Tools Required:**

Safety Glasses

Phillips Screwdriver

Clean Towel or Rag

String

Masking Tape

Thin Metal Blade - Putty Knife

*Note: 3oz Clear Silicone included in the kit*

**Safety Requirements:** *Safety Glasses must be worn at all time during this procedure.*

## **Removing the Pop-Up Speaker**

1. Turn the power off to the spa.

### **On the bartop:**

1. Make sure the water line is below, i.e. 4 ½ - 6 inches, the bartop (normal water level).
2. Using a thin metal blade, i.e. a putty knife, gently pry around the edges of the speaker bezel. It is necessary to break the bezel in order to free up the speaker. **Note: Do not push the pop-up button because it will eject the entire assembly.**
3. If applicable, remove the four screws that hold the speaker in place.
4. Remove the speaker, any silicone, and speaker cable from the opening in the shell.
5. Disconnect the speaker cable from the wire harness at the connector.

### **IR Speaker Removal – the speaker which is used in conjunction with the remote**

6. For the IR speaker, it is necessary to locate the IR Interface Box on the wire harness. Disconnect the IR Sensor Cable and attach a string that is at least 25 feet long. See Figure 1.
7. Remove the speaker as described above and pull the IR Sensor Cable out until the string is exposed. Disconnect the cable from the string and tape the string to the bartop.

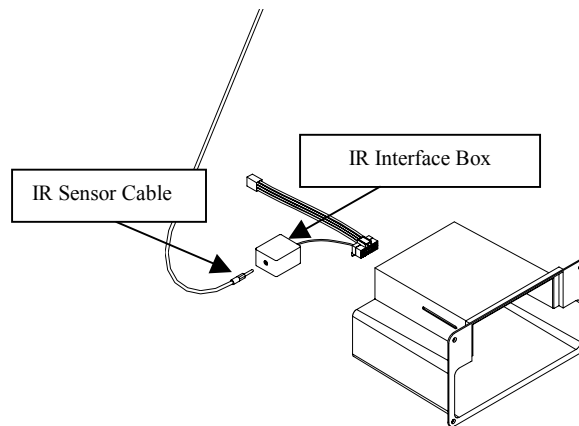
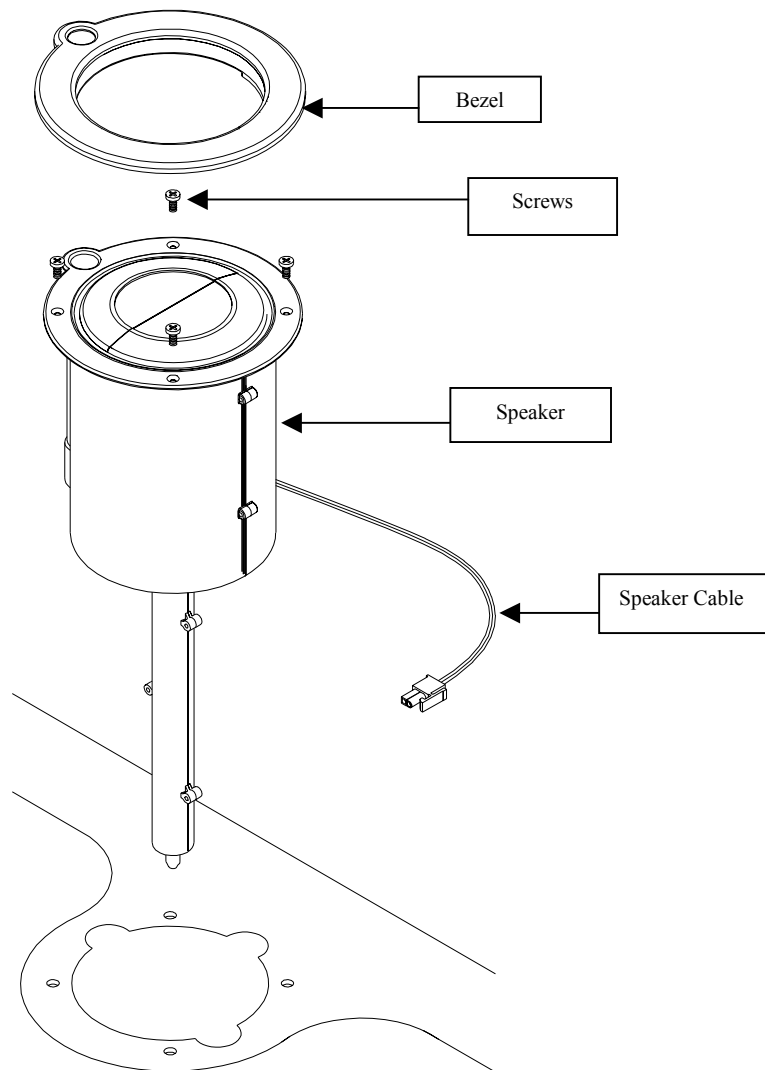

**Figure 1**

**Note:** *If you are returning the speaker with a warranty claim, be sure to package it in original factory packaging (you can use the packaging from the replacement box).*

## Installing the New Pop-Up Speaker

1. Plug the new speaker cable into the main harness speaker cable at the connector.
2. Align the speaker up with the opening.  
**IR Speaker**
  3. Remove the string that is taped bartop and attach it to the IR cable. Pull the cable back to the wire harness.
  4. Plug the IR cable into the IR connector.
  5. Rest the speaker in the location where it will be installed.
  6. Apply power and verify that the speaker is functioning properly.
  7. Place a 1/8" bead of clear silicone to the lip area of the speaker.
  8. Plug the cable into the main harness at the connector, fit the speaker into the shell opening, and press down evenly to secure in place.
  9. Install the four screws.
  10. Use the clean towel or rag to remove any excess silicone from the area.
  11. Snap the bezel onto the speaker.
  12. Inform the spa owner to wait 24 hours before using the spa to allow the silicone to dry completely.



**Figure 2**