

Replacement of Hydromassage Jet Insert

Models: Hot Spring, Tiger River, Solana

This instruction outlines the procedure for replacing the hydromassage jet head used in the Hot Spring, Tiger River, and Solana spas.

Reason for upgrade: Changes have been made to improve the structure and design of the rotary and directional hydromassage jet. The replacement threaded jet inserts are mounted as single pieces instead of the original 3 separate pieces for greater durability.

Replacement Procedure:

To replace a hydromassage jet, follow these steps:

1. Disconnect power to the spa.
2. Unscrew the installed jet and retainer counterclockwise.

Note: Make sure you only remove the jet insert assembly, including the retainer.

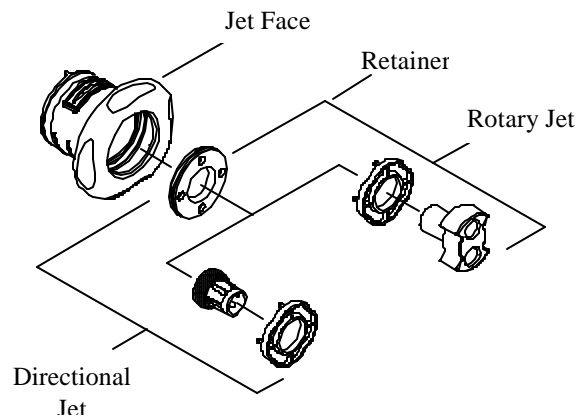

Figure 1: Obsolete Jet Heads with Jet Face

3. Screw in the replacing jet insert.

Note: Make sure the jet insert is screwed in completely, but without over-tightening it.

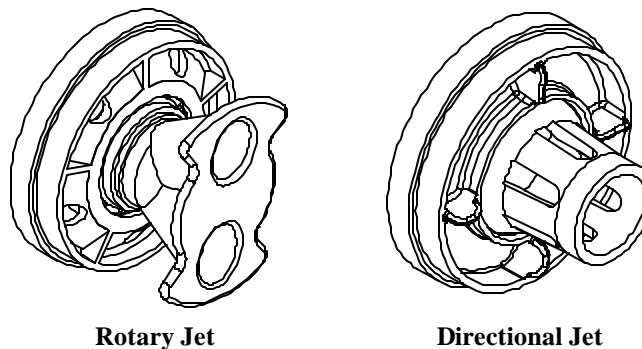

Figure 2: Replacement Rotary and Directional Hydromassage Jets